

# LOW PRESSURE REGULATOR FOR HIGH FLOWRATE 7905



Art.7905-10  
Art. 7905-20



Art. 7905-1,5  
Art. 7905-6  
Art. 7905-40

The application of this single-stage regulator is everywhere, where in spite of a low inlet pressure a high flowrate is required. This is particularly the case in distribution pipelines from liquid tanks with subsequent vaporization.

The regulator is a diaphragm regulator which is characterized by a high flowrate (depending on pressure ratio up to 450 Nm<sup>3</sup>/h) even with a relatively small difference between inlet and outlet pressure. And this with a high pressure constancy.

Thanks to the compact design, the regulator is light in weight, very robust and therewith not susceptible for breakdowns. The regulator is suited for oxygen (ignition test for oxygen BAM).

The regulator is available in versions for 1.5, 6, 10, 20 and 40 bar working pressure. The maximum inlet pressure is 50 bar.

## Technical specification :

Inlet pressure:	: max. 50 bar
Outlet pressure	: 0 - 1.5 bar, 0 - 6 bar, 0 - 10 bar, 0 - 20 bar, 0 - 40 bar
Maximum flowrate	: 450 Nm <sup>3</sup> /h (see flow diagrams)
Gases	: all gases and gas mixtures except corrosive or poisonous gases
Inlet	: G1/2" outer thread (with wire mesh filter), G3/4" inner thread
Outlet	: G1/2" inner thread, G3/4" inner thread (as option with nipple G1/2" outer thread, resp. G3/4" outer thread)
Material	: body brass, diaphragm NBR, sealing material EPDM/FPM/PA6/POM, filter made of stainless wire mesh
Operating temperatures	: -20 up to +60C°
Weight	: 2.3 kg (version 10 and 20 bar), 2.6 kg (version 1,5, 6 and 40 bar)

# GLOOR

**Flow diagrams:**

7905-40 (inlet pressure 50bar)

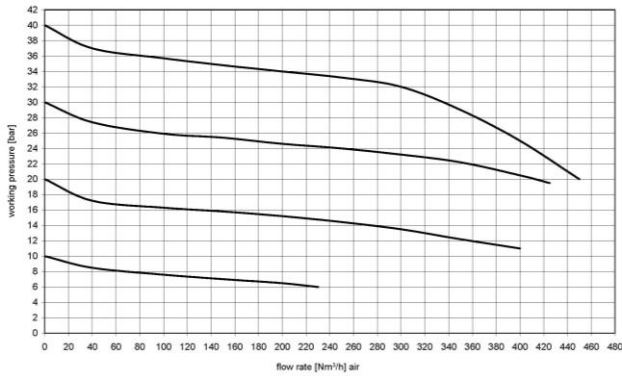

7905-20 (inlet pressure 30bar)

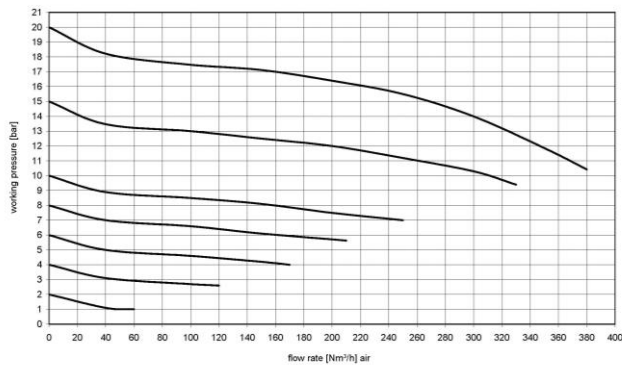

7905-6 (inlet pressure 12bar)

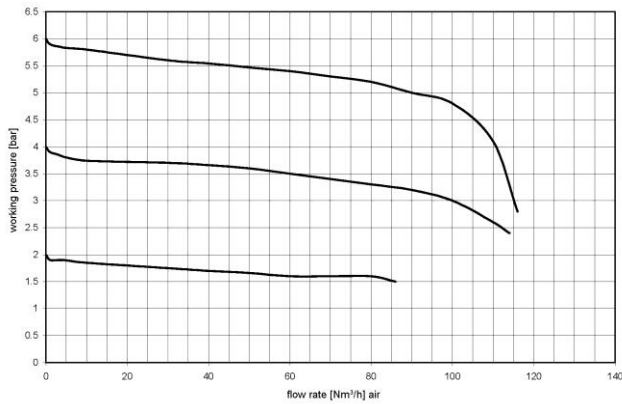

7905-1.5 (inlet pressure 5bar)

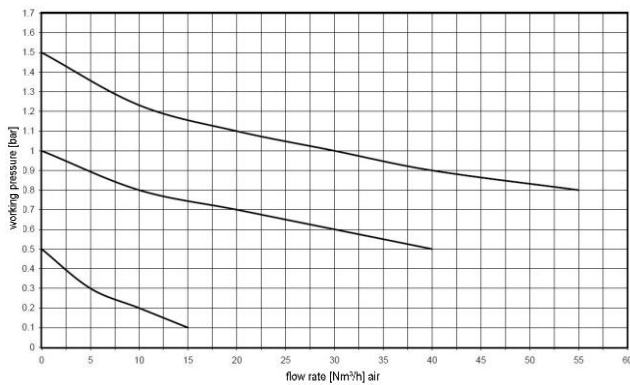

**Dimension:**

7905-1,5; 7905-40; 7905-6; 7905-1,5-3/4;  
7905-40-3/4; 7905-6-3/4

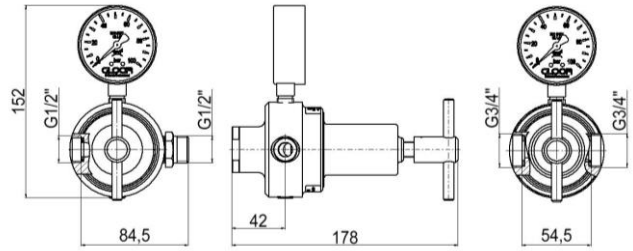

**Dimension:**

7905-10; 7905-20; 7905-10-3/4; 7905-20-3/4

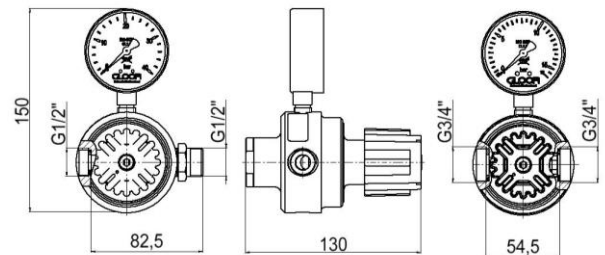

**Dimensions incl. nipple outer thread:**

7905-1,5; 7905-6; 7905-40

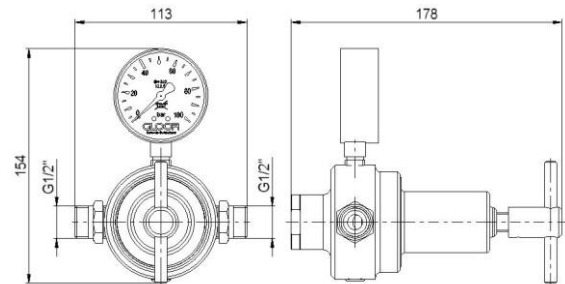

**Dimensions:**

7905-10; 7905-20

